

# Content

G Series Equipment List .....	1
G Series Operation Manual .....	2
1、 Overview .....	2
2、 E-Paper Electronic Paper Information Board .....	2
2.1 Specifications .....	3
2.2 Battery Installation .....	3
2.3 Bracket .....	5
2.4 Features .....	7
2.5 Scope of Application .....	7
3、 WT E-Paper and WTDegnsier Introduce .....	8
3.1 WT E-Paper APP Download Method .....	8
3.2 WT E-Paper APP Account Registration .....	9
3.3 WT E-Paper APP Function .....	10
3.3.1 Module 1: Device .....	10
3.3.2 Module 2: Template editing function interface .....	11
3.3.3 Module 3: My homepage .....	14
4、 WTDegnsier Template Design Tool .....	15
4.1 WTDegnsier Template Design Tool Download .....	15
4.2 WTDegnsier Template Design Tool Function .....	18
4.2.1 Module 1: New .....	19
4.2.2 Module 2: My file .....	21
4.2.3 Module 3: Recently .....	22
4.2.4 Module 4: My Cloud Templates .....	22
4.2.5 Module 5: Templates Community .....	25
4.2.6 Module 6: Collection .....	25
4.2.7 Module 7: Recycle .....	26
4.2.8 Module 8: Plugs .....	26
5、 Briefly Describe The Steps To Update The Template .....	27
6、 Briefly describe the steps of WTDegnsier template design tool .....	28

Version update point:

→ Ver 1.0 initial version

→ Ver 1.2 WT E-Paper APP update content:

Added Cloud Templates module account interoperability and general functions/  
form template text and template editing functions

WTDegnsier template design tool updates:

Added form, language switching, cloud template sharing template function/  
App and my cloud template account interoperability function/"Public Template"  
was renamed "Template Community" and the sharing function was cancelled

→ Ver 1.4 WTDegnsier template design tool version 2.0 and version 2.2 are updated and add a

## 2.9-inch standing bracket

### WTDegnsier template design tool version 2.0 updates:

Added a new plug-in extension to support the image projection function of S series devices, support software self-upgrade, and retain user local data

Note: For users of versions below 2.0, open this tool interface and the following update prompt will pop up to upgrade to version 2.0.

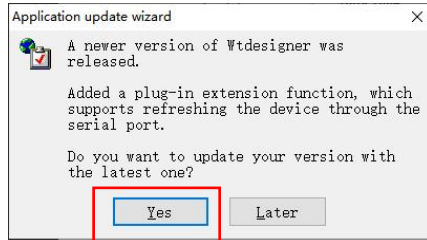

Yes update version 2.0

Later, the next time you open the interface, you will be prompted to update.

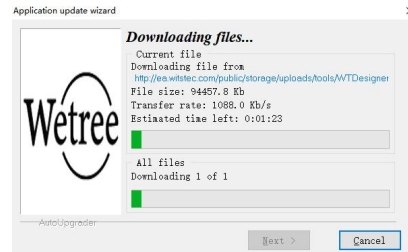

After clicking Yes, the update progress bar appears,

After the update is completed, click OK to pop up the version 2.0 installation interface. For details on the installation tutorial, see Step 3 on page 16 of this manual.

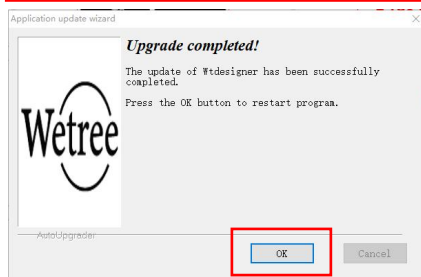

### WTDegnsier template design tool version 2.2 updates:

The software icon has been changed, the cloud template account login page has been changed to the software homepage login, template design has been optimized: the function of adjusting location attributes has been added, and extension plug-ins are displayed in the software module list and displayed in a table format.

Note: For users of version 2.1, open this tool interface and the following update prompt will pop up to upgrade to version 2.2.

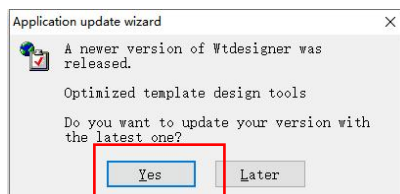

[Y] Update version 2.2

[L] Next time you open the interface, you will be prompted to update.

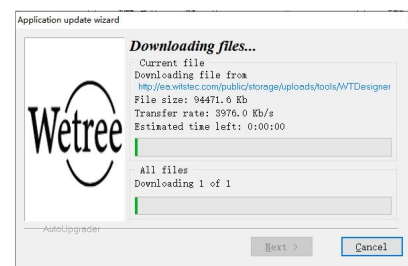

After clicking [Y], an update progress bar appears and the update is in progress.

After the update is completed, click [o] to pop up the version 2.2 installation interface. For details on the installation tutorial, see Step 3 on page 16 of this manual.

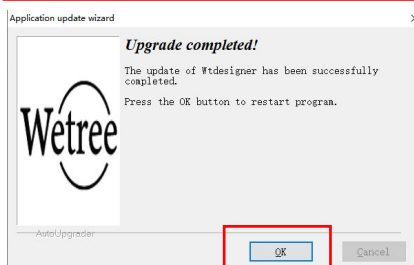

## G Series Equipment List

Name	Model	Color	Quantity	Remark
G series device 2.9 inch (single screen)	BHR29AS	Black White Red	Users can use multiple units	This device is suitable for Picking labels, warehouse signage, price tags, work cards, etc.
G series device 4.2 inch (single screen)	BHR42AS	Black White Red		
G series device 7.5 inch (single screen) (standing/hanging)	BHR75BS	Black White Red	Users can use multiple units	This device is suitable for meeting table Card, Seat cards,etc.
G series device 7.5 inch (single screen)	BTR75AS	Black White Red	Users can use multiple units	This device is suitable for doorplate, department logo office information board, hospital information board Picking goods label,etc.
G series device 10.2 inch (single screen)	BTRA2BS	Black White		
	BTRA3AS	Black White Red		
G series device 11.6 inch (single screen)	BTRB6BS	Black White		
	BTRB6AS	Black White Red		
WT E-Paper APP	——	——	1	This APP mobile phone use Support IOS/Android system
WTDegnsier template design tools	——	——	1	Use this tool on a computer

Wetree reserves all rights to this document and the information contained herein. Products, names, logos and designs described herein may in whole or in part be subject to intellectual property rights. Reproduction, use, modification or disclosure to third parties of this document or any part thereof without the express permission of Wetree is strictly prohibited.

The information contained herein is provided “as is” and Wetree assumes no liability for the use of the information. No warranty, either express or implied, is given, including but not limited, with respect to the accuracy, correctness, reliability and fitness for a particular purpose of the information. This document may be revised by Wetree at any time. For most recent documents, visit [www.witstec.com](http://www.witstec.com)

Copyright © 2023, Shenzhen Witstec Technology Co.,LTD.

Wetree® is a registered trademark of Shenzhen Witstec Technology Co.,LTD, Ltd. in China.

# G Series Operation Manual

## 1、 Overview

This manual mainly introduces the instructions for using the electronic paper information display board of G series products. The realization of its function depends on 2 factors:

① Electronic paper information card (E-Paper) equipment, ② WT E-Paper mobile APP and WTDegnsier template design tool. The whole process is as follows: Make a template on the mobile APP WT E-Paper, and then send it to the electronic paper information board. The transmission technology it uses is Bluetooth 5.0 transmission technology. WT E-Paper mobile APP and WTDegnsier template design tool can make templates on mobile phones/computers, so that users can have more choices and use more conveniently.





## 2、 E-Paper Electronic Paper Information Board



The E-Paper electronic paper information card is the main body of the price tag information display, and the template is sent to the device after the WT E-Paper mobile APP is completed. You can also create a template on the WTDegnsier template design tool and save it on My Cloud Template, and the APP can log in to the same My Cloud Template account to get the template for use and send it to the device.



## 2.1 Specifications

E-Paper is currently available in sizes 2.9", 4.2", 7.5", 10.2", 11.6". The specifications are shown in the table below.

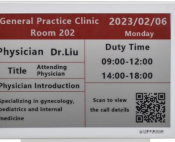
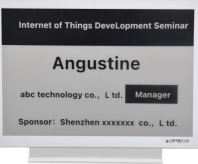
Size	2.9" single screen	4.2" single screen	7.5"(standing/hanging)	7.5" single screen
Product photo				
Screen type	E-ink screen	E-ink screen	E-ink screen	E-ink screen
Display color	黑白红	黑白红	Black White Red	Black White Red
Display resolution (pixels)	296*128	400*300	800*480	800*480
Display size (mm)	66.9(H)*29.06(V)	84.8(H)*63.6(V)	163.24(H)*97.94(V)	163.24(H)*97.94(V)
Overall size (mm)	98.7(H)*46.1(V)*13.9(D)	104.8(H)*87.6(V)*13.0(D)	115.0(H)*201.0(V)*(D)	181*(H)*126(V)*7.2(D)
Battery capacity	1200mAh	2400mAh	3600mAh	Rechargeable model
DPI	112	119	124	124
Working temperature	0-40℃	0-40℃	0-40℃	0-50℃
Transmission technology	Bluetooth	Bluetooth	Bluetooth	Bluetooth
Material	ABS	ABS	ABS	ABS

Size	10.2" single screen	10.2" single screen	11.6" single screen	11.6" single screen
Product photo				
Screen type	E-ink screen	E-ink screen	E-ink screen	E-ink screen
Display color	Black White	Black White Red	Black White	Black White Red
Display resolution (pixels)	960*640	960*640	960*640	960*640
Display size (mm)	215.52(H)*143.68(V)	215.52(H)*143.68(V)	244.512(H)*163.008(V)	244.512(H)*163.008(V)
Overall size (mm)	235(H)*170(V)*7.2(D)	235(H)*170(V)*7.2(D)	268(H)*192(V)*7.2(D)	268(H)*192(V)*7.2(D)
Battery capacity	Rechargeable model	Rechargeable model	Rechargeable model	Rechargeable model
DPI	113	113	100	100
Working temperature	0-50℃	0-50℃	0-50℃	0-50℃
Transmission technology	Bluetooth	Bluetooth	Bluetooth	Bluetooth
Material	ABS	ABS	ABS	ABS

## 2.2 Battery Installation

G series electronic paper screen information board equipment , need to be equipped with batteries. The number of batteries installed in different sizes of devices is different:

2.9" devices have 2 batteries,

4.2" devices have 4 batteries,

7.5" devices have 3 batteries,

10.2" and 11.6" devices have 6 batteries.



#### 4.2" single-screen electronic price tag battery installation

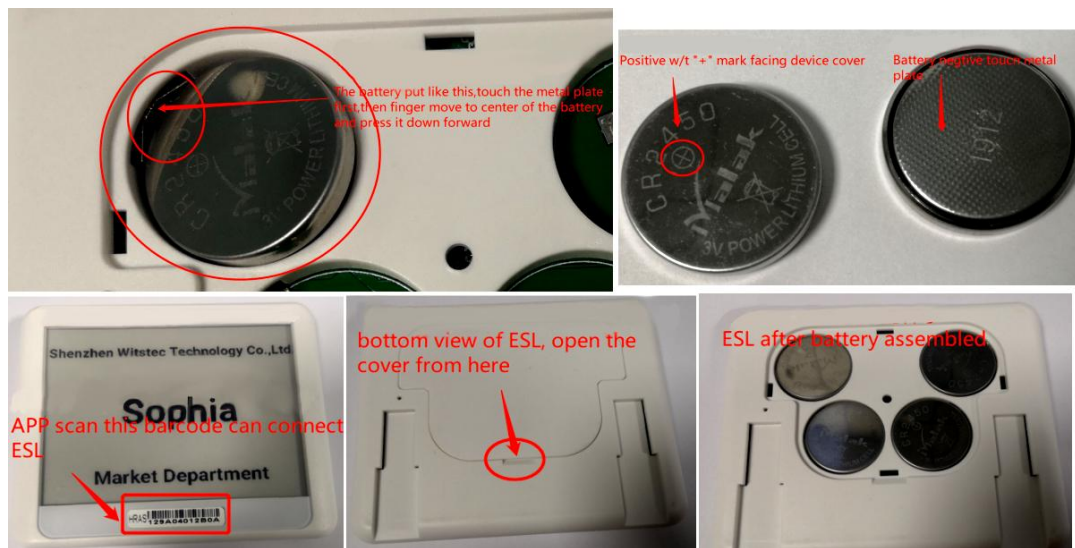

#### 2.9" single-screen electronic price tag battery installation

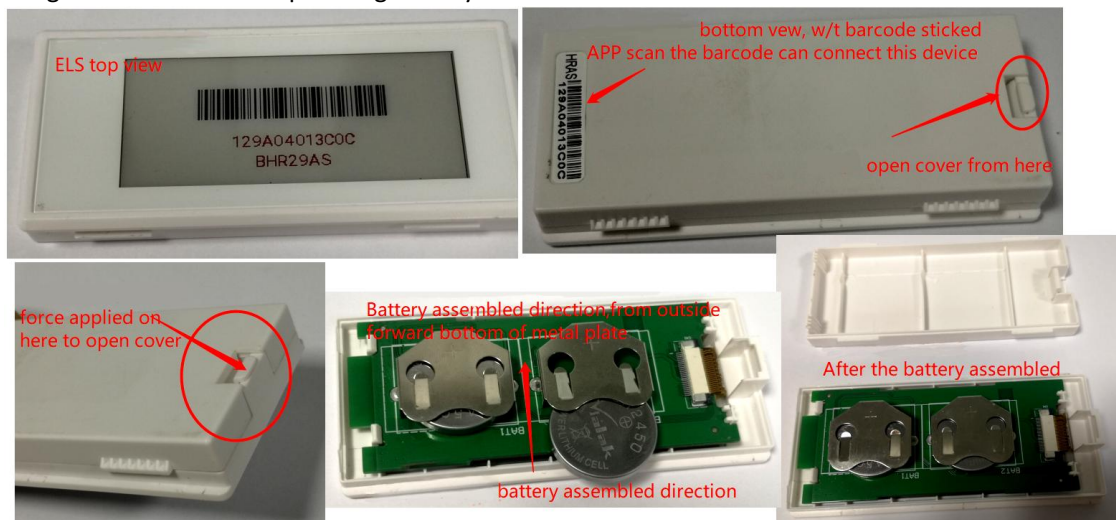

#### 7.5" standing/hanging electronic table card battery installation

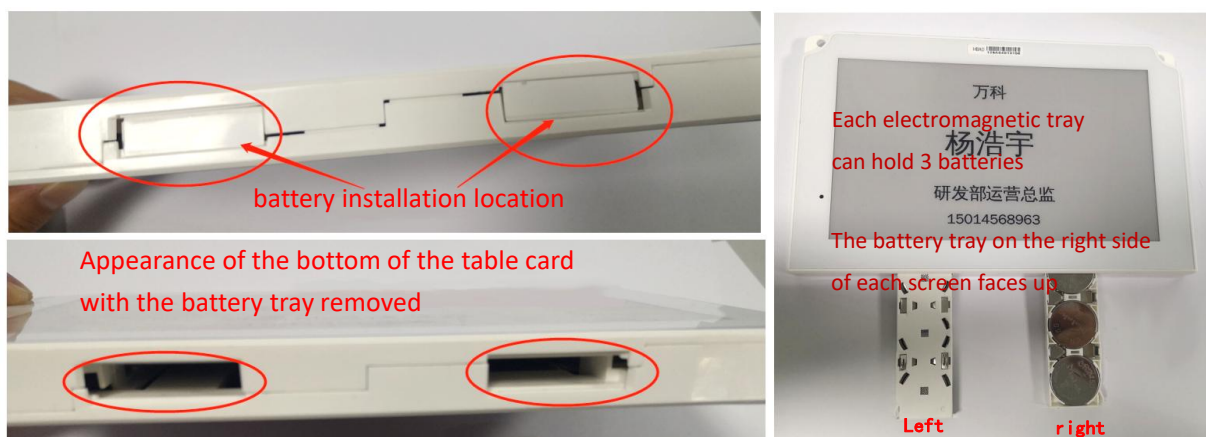

#### 7.5 "10.2" 11.6" single-screen department brand battery installation

→ For 7.5" single-screen 10.2" single-screen and 11.6" single-screen devices, remove a screw on the back and slide the back cover manually to replace the battery.

## 2.3 Bracket

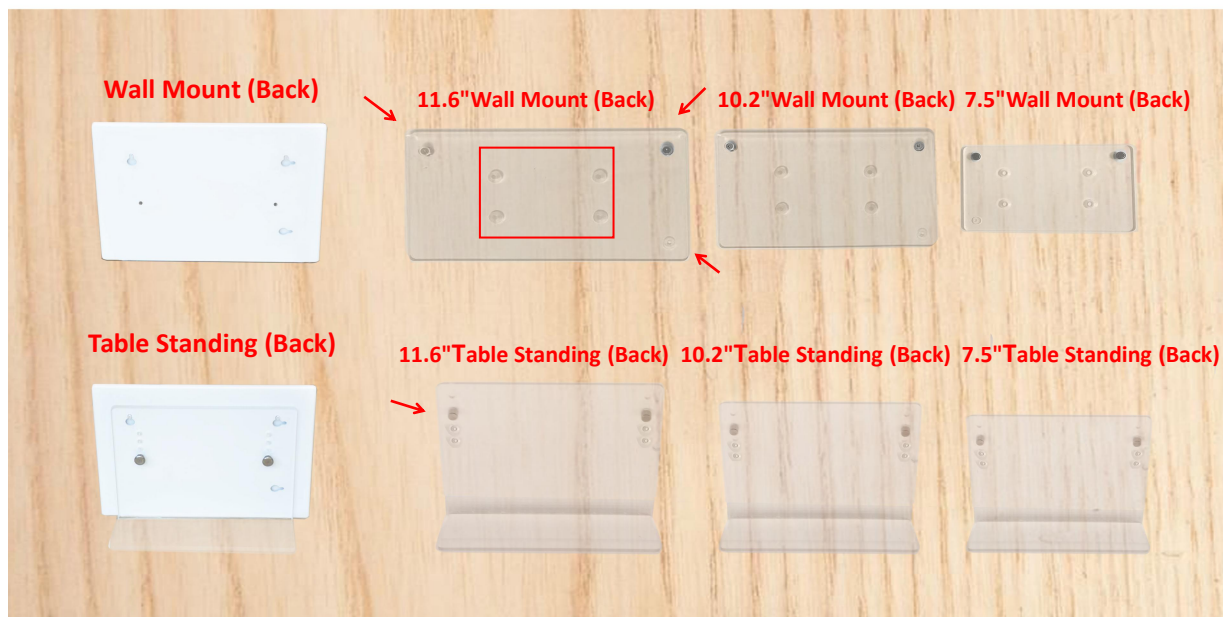

### → Instructions for wall hanging:

There are three holes on the bracket to tighten two screws "horizontal/vertical" to fix

There are four holes in the bracket for "horizontal/vertical" screw fixing on the wall or door

Installation method: After the four holes in the bracket are fixed on the wall or door, hang the three holes on the back of the device on the bracket according to the "horizontal/vertical" requirements

### → Desktop Stand Instructions:

There are three holes in the bracket to "raise/lower" Tighten two screws to fix

Installation method: The three holes in the bracket correspond to the left and right holes on the back of the device to "raise/lower" the height and tighten the screws.

## 2.9-inch shelf bracket

When purchasing a 2.9-inch product, two brackets will be delivered, one is a hanging bracket and the other is a card-type bracket.

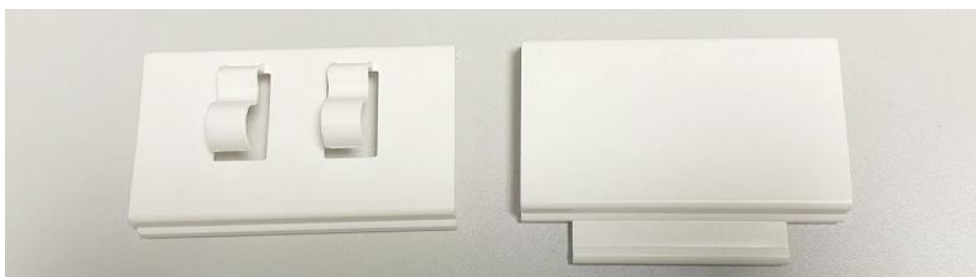

**Hanging bracket (back)**

**Card bracket (back)**

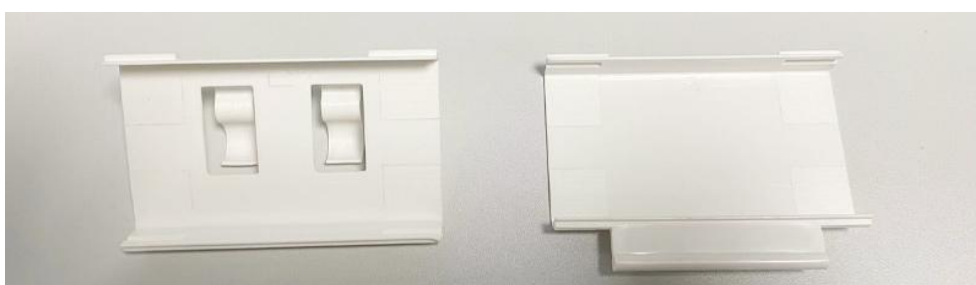

**Hanging bracket (front)**

**Card bracket (front)**

→ Hang bracket description:

The curved hook on the back of the stand can be hung on the shelf or placed on the shelf table for use

Installation method: directly attach the hanging bracket to the buckle of the 2.9-inch product

→ Card bracket description:

The bracket can be used with the "Shelf Standing Bracket" or attached to the shelf.

Installation method: Directly attach the card bracket to the buckle of the 2.9-inch product

→ Card bracket usage scenario is as shown below:

Scenario 1: Attach the Card bracket to the shelf, and then snap the 2.9-inch product onto it for easy access to replace the battery



Scenario 2: Clamp the Card bracket on the 2.9-inch product buckle, and then use the "shelf standing bracket" to clamp the clip of the shelf standing bracket to the tail of the Card bracket. The two brackets can be used together to highlight the height of the label.

Can be displayed on shelves or countertops

**2.9 inch"shelf stand bracket**

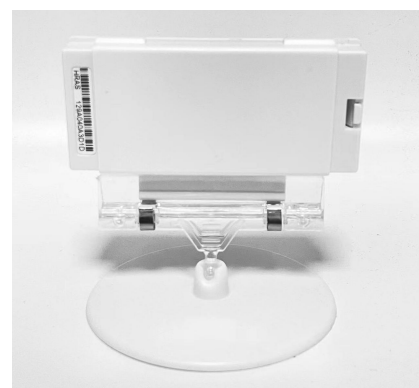
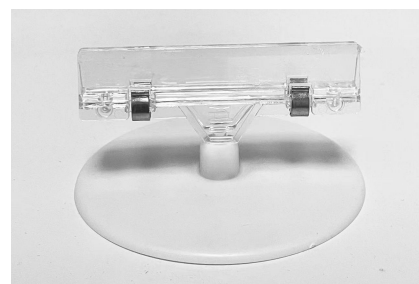



## 2.4 Features

- a.No base station, mobile phone Bluetooth wireless update
- b.Ultra-low power consumption, the E-ink screen can continue to display the last content without power consumption
- c.WT E-Paper online update
- d.WTDesigner my cloud template communication and sharing
- e.Fast update
- f.DIY interface supports text/barcode/QR code/picture/logo/graphic/table

## 2.5 Scope of Application

According to the characteristics of G series products , it can be used as electronic paper display information board. for example:

- a. 2.9", 4.2" electronic price tags, station tags, warehouse signs, labels, production information, other product information labels, etc.
- b. 7.5" electronic table cards, hospital bedside cards, information push cards, office seat signs, house signs, warehouse signs, etc.
- c. 10.2", 11.6" department cards, office information cards, hospital information cards, billboards, display information display cards, etc.

All the above applications can display the content of the application in any size , and users can choose the device according to their own needs.



electronic price tag



warehouse label





### 3、WT E-Paper and WTDegnsier Introduce

The function of WT E-Paper mobile APP is to make templates and send templates, and the function of WTDegnsier template design tool is to make templates. The WT E-Paper mobile APP prepares templates and transmits data to the device through Bluetooth. The template made by WTDegnsier template design tool, save the template in my cloud template, log in to my cloud template account on the mobile phone to get the template in my cloud template, and then download the template on the WT E-Paper mobile APP for editing Or send the template directly to the device.

Both the PC version of WTDegnsier template design tool and the WT E-Paper mobile APP can create templates, which are the source of information displayed on G series products. The computer version of WTDegnsier template design tool version 2.0 has a plug-in extension function. Users with G series and S series devices can install the plug-in extension function of the S series. In this way, templates can be sent through the template design tool without downloading the S series software. , to refresh the S-series device.

WT E-Paper mobile APP consists of four functional interface modules: equipment, template, drawing, and mine. After you edit the content on the WT E-Paper APP, turn on the Bluetooth function, connect the device, select the corresponding template, and the template can be transferred to the device. This software contains many editing functions, including inputting text, inserting pictures and graphics, barcodes, QR codes, adjusting the position and size of the entered content, etc.

#### 3.1 WT E-Paper APP Download Method

The WT E-Paper app can be searched and downloaded from the App Store/Google Play. You can also directly scan the QR code below to download. The WTDegnsier template design tool needs to be downloaded and used on the computer. You can copy the following URL on the computer or scan the QR code to open the download with a browser.



WT E-Paper



Templates Designer WTDesigner 

A. App Store download link and QR code (WT E-Paper mobile app)

<https://apps.apple.com/cn/app/wt-e-paper/id1509849549>



B. Google Play download link and QR code (WT E-Paper mobile app)

<https://play.google.com/store/apps/details?id=com.witstec.epaper>



C. Android APK download link and QR code (WT E-Paper mobile app)

<https://dev.witstec.com/DownloadCenter/getAndroid/G>



### 3.2 WT E-Paper APP Account Registration

New users need to register a login account before designing and sending templates on WT E-Paper.

Steps: Open the WT E-Paper mobile APP → click "Register New User" → enter the registered email address, user name, password → click "Register"

(Note: WTDesigner My Cloud template and WT E-Paper APP account are interoperable, choose one to register and use it synchronously and log in)

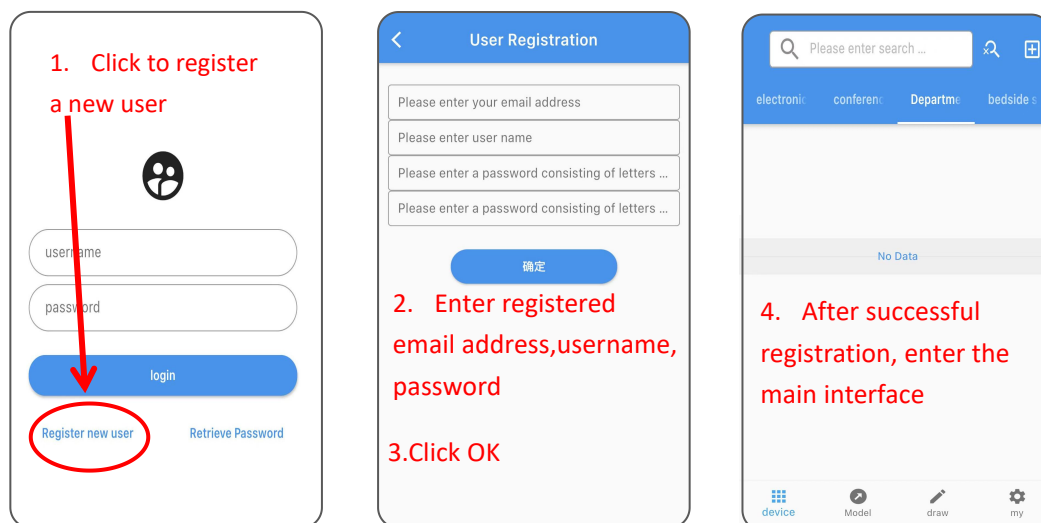

### 3.3 WT E-Paper APP Function

#### 3.3.1 Module 1: Device

After you enter the WT E-Paper mobile phone APP, you enter the function module of the APP, and you need to connect the device to this module before sending the template to the device. This module is divided into four application types according to the applicable scenarios: electronic price tags, conference table cards, department cards, and bedside cards.

You can click the names of these four interfaces to switch between different application types.

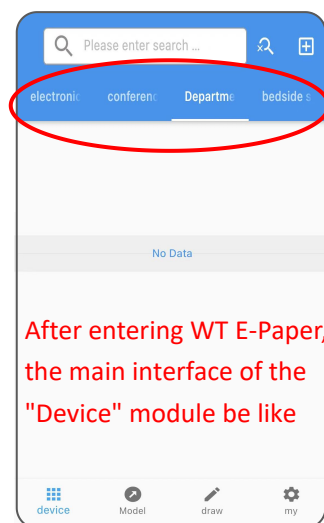

After entering WT E-Paper,  
the main interface of the  
"Device" module be like

##### 3.3.1.1 How to connect the device

Steps: Click "+" in the upper right corner → select the corresponding "application device" to scan and connect → click the ID binding of the required application device. There are too many device bindings and it is difficult to find. You can enter the device number in the search bar to find it precisely. Select the corresponding device or swipe up to view more bound devices.

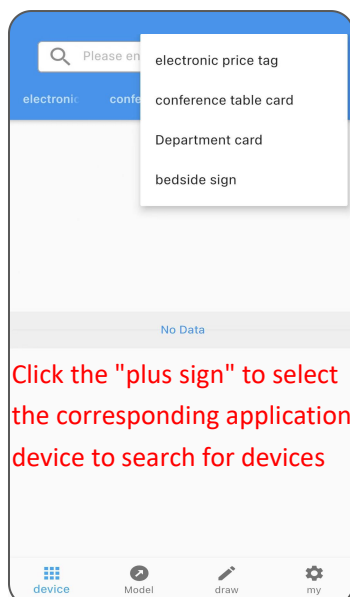

Click the "plus sign" to select  
the corresponding application  
device to search for devices

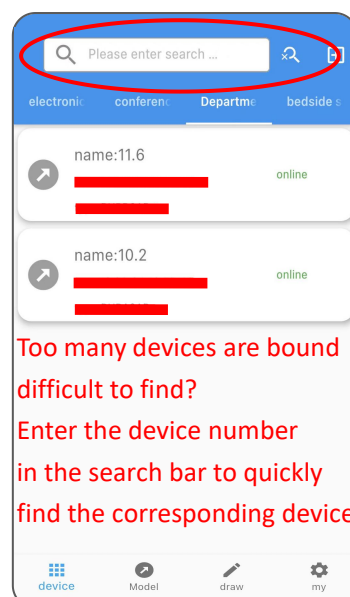

Too many devices are bound  
difficult to find?  
Enter the device number  
in the search bar to quickly  
find the corresponding device

### 3.3.2 Module 2: Template editing function interface

Users can draw templates on the WT E-Paper mobile APP. After drawing, they can view the template records that have been made and send them to the device.

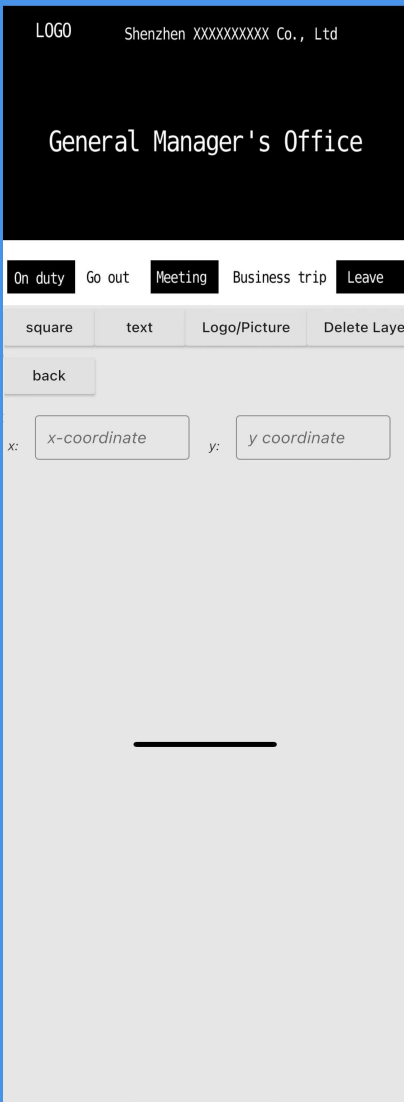
Template edit page	icon	Function							
	square	<p>function of square</p> <ol style="list-style-type: none"><li>1. Square graphic size: enter the size parameters to set the graphic size or zoom the graphic size with two fingers, or drag the arrow to change the size/360 rotation</li><li>2. Square graphic position: move the graphic position left and right up and down with single finger or input coordinate parameters to move</li><li>3. Square graphics color: can be set to (black, red, white)</li><li>4. Use of square graphics: can be set as background or style</li></ol>							
	text	<p>function of text</p> <ol style="list-style-type: none"><li>1. Text editing: input text content</li><li>2. Text size: enter the font parameters to set the font size or zoom the font size with two fingers, also can drag the arrow to change the size/360 rotation.</li><li>3. Text position: move the text position with single finger left, right, up and down or enter coordinate parameters to move</li><li>4. Text color: font color can be set (black, red, white)</li></ol>							
	Logo/Image	<p>function of Logo/Image</p> <ol style="list-style-type: none"><li>1. Logo/picture editing: Logo/picture/QR code/barcode can be added</li><li>2. Logo/picture size: enter the Logo/picture/QR code/barcode size parameter to set the size or zoom with two fingers, or drag the arrow to change the size or 360 rotation.</li><li>3. Logo/picture position: move the position of Logo/picture/QR code/barcode with one finger left and right, up and down or enter coordinate parameters to move</li></ol>							
	delete layer back	<table><tr><td>function of delete layer</td><td>back function</td></tr><tr><td>1. Delete squares</td><td>1. You can go back to the previous step</td></tr><tr><td>2. Delete text</td><td></td></tr><tr><td>3. Delete logo/ picture</td><td></td></tr></table>	function of delete layer	back function	1. Delete squares	1. You can go back to the previous step	2. Delete text		3. Delete logo/ picture
function of delete layer	back function								
1. Delete squares	1. You can go back to the previous step								
2. Delete text									
3. Delete logo/ picture									

#### 3.3.2.1 Steps for making a template

1. Go to the "Template" module of WT E-Paper
2. Click the "+" in the lower right corner to select the device size.
3. Enter the template creation interface and use the drawing function to create a template
4. After the template content is created, click the "save icon" in the upper right corner
5. Name the template and click "OK" to save the template



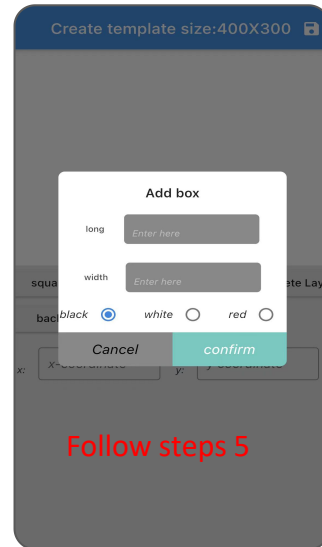
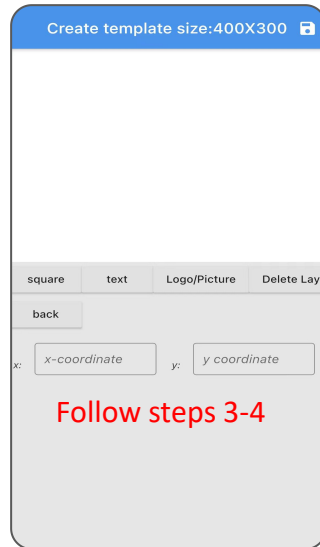
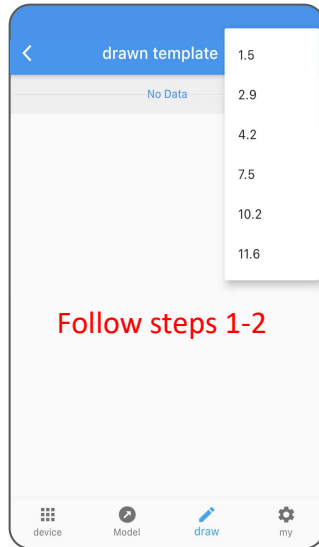

### 3.3.2.2 How to query templates

After the template is made, it will be saved under the drawing module. After entering WT E-Paper, click on the "Draw" module to see the completed template. When you make a lot of templates, you can manually swipe up and down to view the template records or long press the template to delete the template you don't like. You can also click "Template" module, manually slide up and down to view the templates of different template communities and my cloud template records, and long press to download to the drawing module for secondary editing and modification.

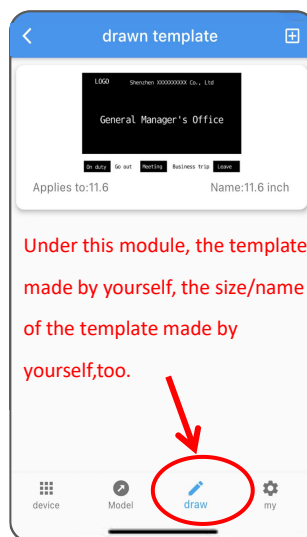
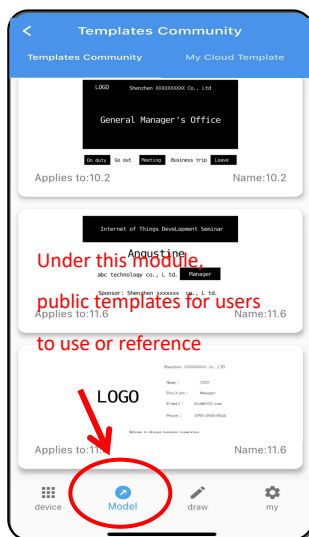

### 3.3.2.3 How to send template to device

1. Select the device application type
2. Connect the corresponding device ID
3. Name the device and click OK
4. Click the added device to connect the device
5. Click "Choose Template"

6. Enter the "template community" and "my cloud template" "self-drawn template" interface to select the template to be sent
7. After selecting the required template, you can edit the template information to change, after changing the content or not changing the content, click "Send to Device"
8. Wait for about 10-15 seconds, (the less the screen color, the faster the refresh) the template can be successfully sent to the device. After the refresh is completed, it will automatically return to the selected device interface

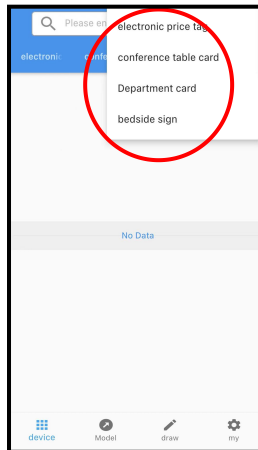

1. Connect the device, click the + sign in the upper right corner, select the device application type to search for the device

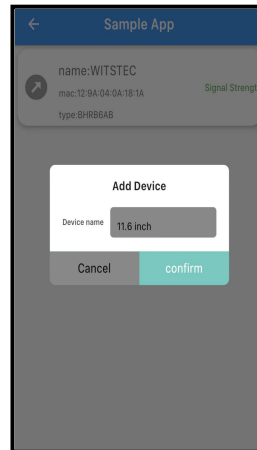

2. Search for the device, click the application type to automatically detect the device of the applied type, click the corresponding device/name, click OK to add

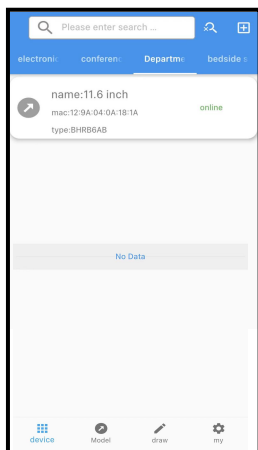

3. After the device is added successfully, click the online device to enter the template selection

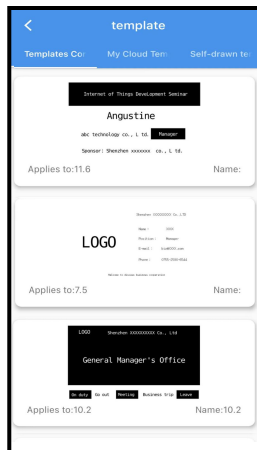

4. Template selection, you can choose a public template or a self-drawn template to send to the device, click the template to be selected to enter the template editing

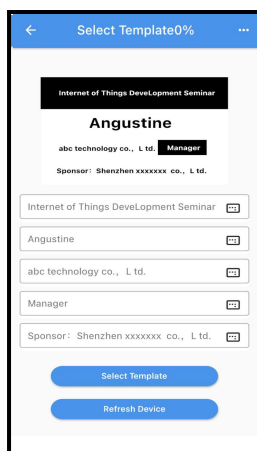

5. Template editing, after the template content is edited, click refresh device to send to the device, and automatically return to the home page after the refresh is completed

Note: If you need to use the format of the existing template, but need to change the content of the existing template, go to the above template editing, change the content of the template, and then click "Send to Device". This operation will not affect the original template, that is, the content of the existing template will not be changed.

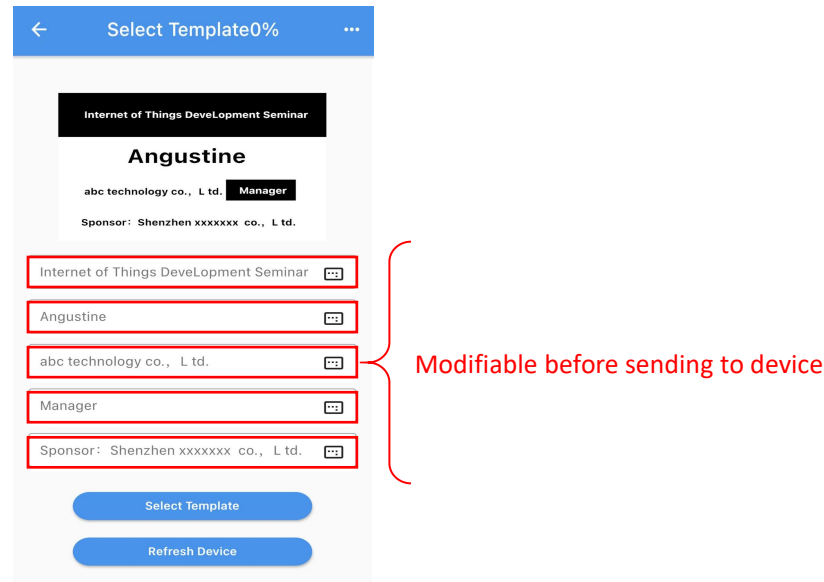

### 3.3.3 Module 3: My homepage

In this module, users can modify the password of the login account, update the version, view the APP version, log out, etc. The details are shown in the figure below.

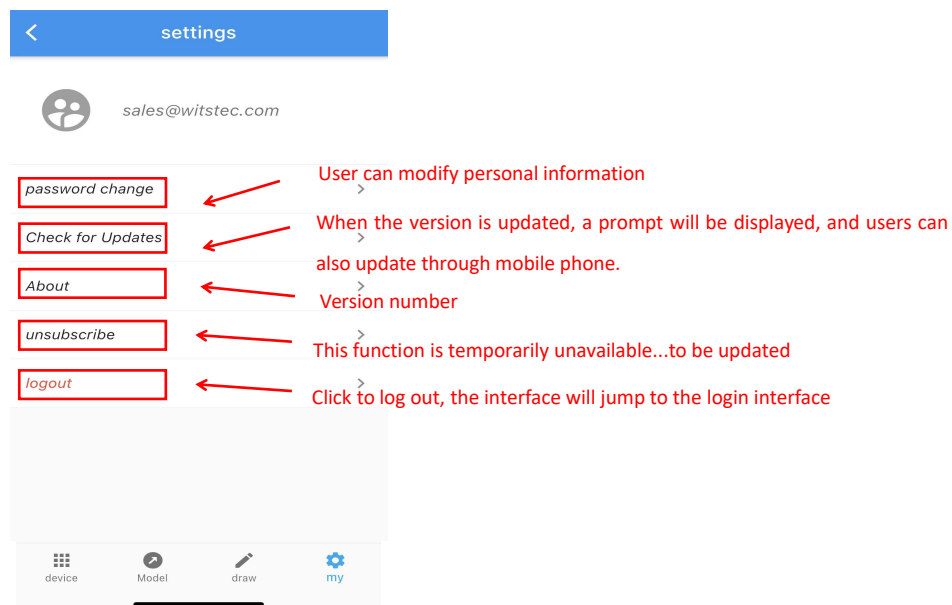

## 4、WTDegnsier Template Design Tool

### 4.1 WTDDesigner Template Design Tool Download

Step 1: Open the browser and enter <https://www.witstec.com/download-2/> to enter the download center of the official website of Witstec

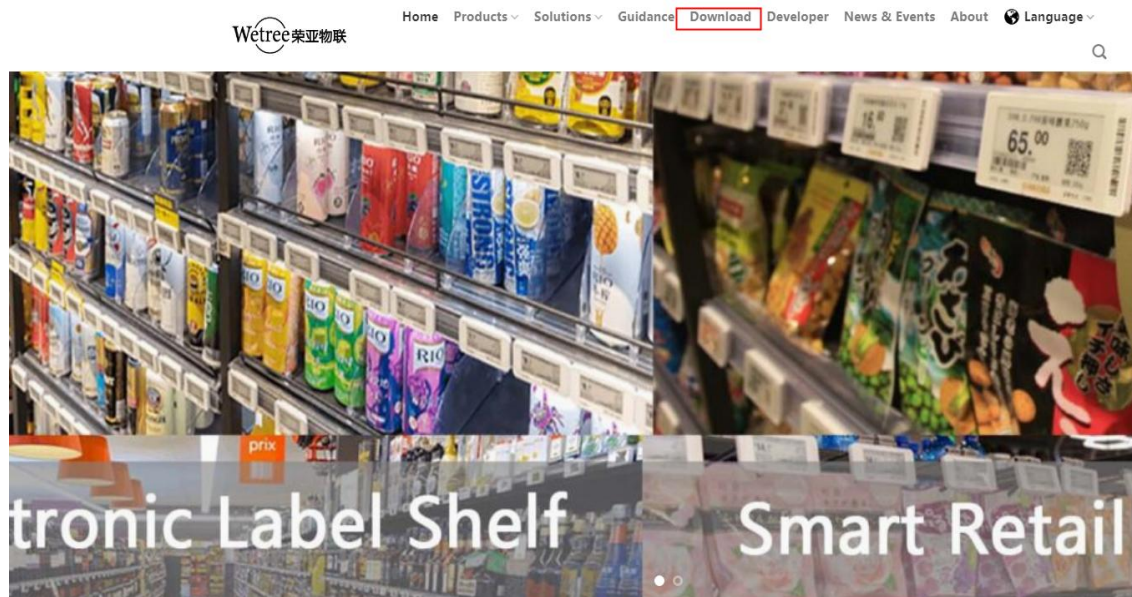

Step 2: Enter the Witstec official website and scroll down and click the "download link" of the WTDegnsier template design tool.

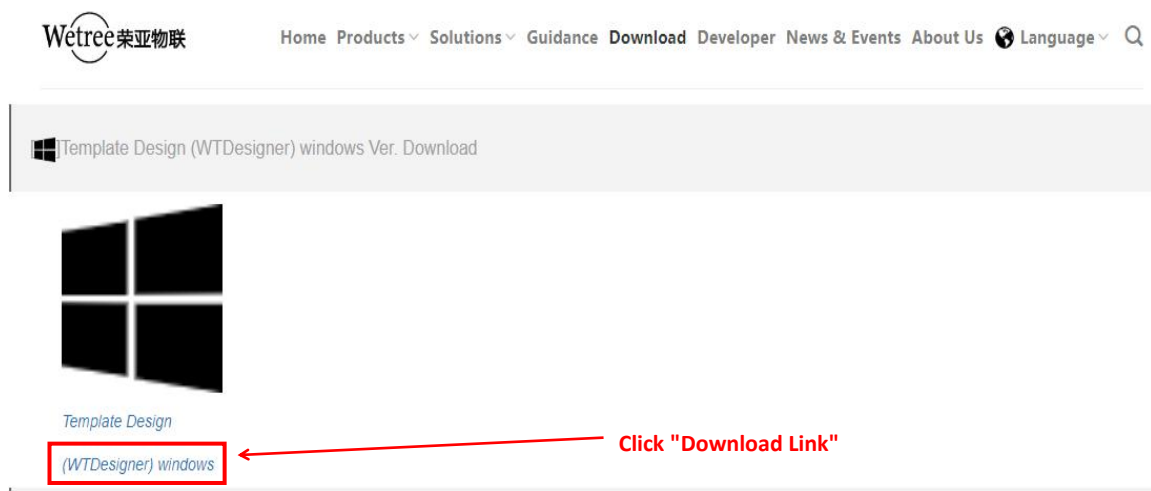

Step 3: After the download of the WTDesignersoftware is complete, find the folder where the download is stored, and click "Run". Then select the prompt to allow the next step.

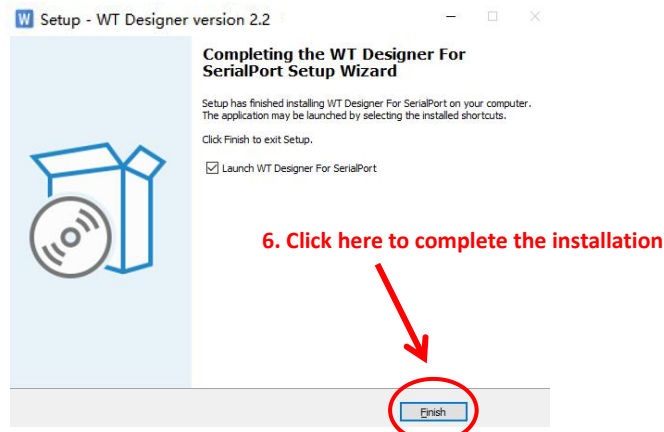
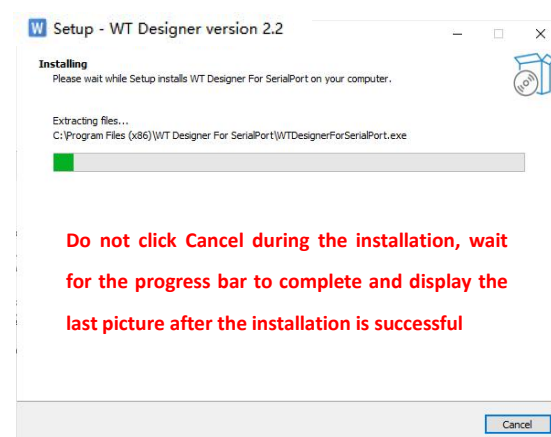
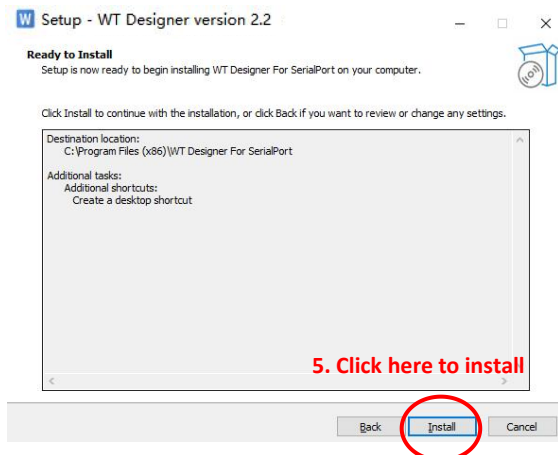
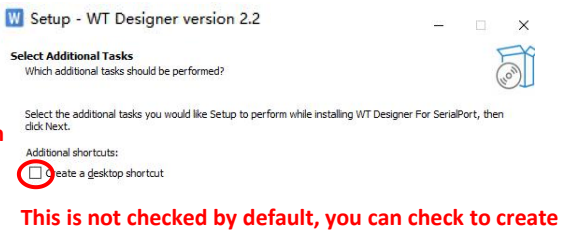
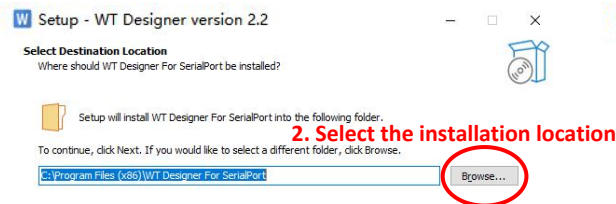
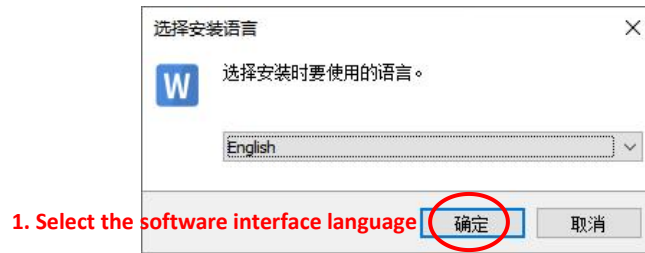



Remarks: If you need to uninstall and reinstall this software, you can click "unins000" on the previous installation disk to uninstall this software, and then download it again.



After the installation is complete, double-click the icon of WTDesigner in the desktop shortcut or the folder where the installation is stored to open the software. The icon after downloading is as follows:



Why register or log in to an account? --WT Designer account is only used for multi-end synchronization and sharing of my cloud templates and App data, which improves product usage efficiency and enriches the display effect of electronic paper devices.

After opening the WTDesigner software, you will enter the login interface by default. The account you log in is my cloud template account. Users can register and log in here, or they can choose local mode to enter the software homepage without using an account. However, when entering the cloud template, you will be prompted. You must log in to your account to enter My Cloud Templates and use the template synchronization and sharing functions.

Open the software → click "Account Registration" (users who have not registered need to register an account by email first) → after the registration is completed, enter the registered email account and login password → click to log in → you can enter the software homepage and my cloud template

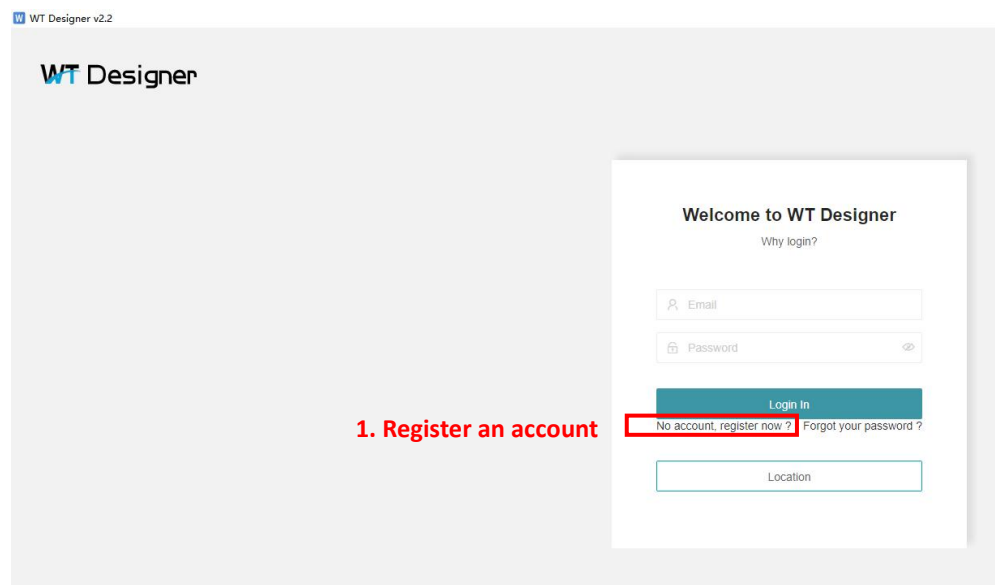

### Welcome to WT Designer

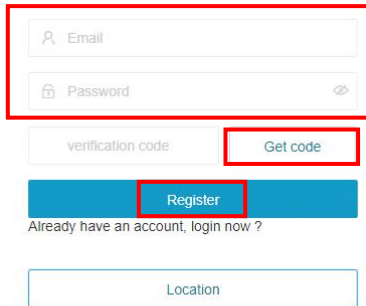

The registration form includes fields for Email, Password, verification code, and a Get code button. Below these is a Register button and a link for users who already have an account. At the bottom is a Location field.

2. Enter the email account and set the login password

3. Click "Get Verification Code" and enter the verification code received by email

4. Click "Register", after successful registration, you can enter the login interface

### Welcome to WT Designer

Why login?

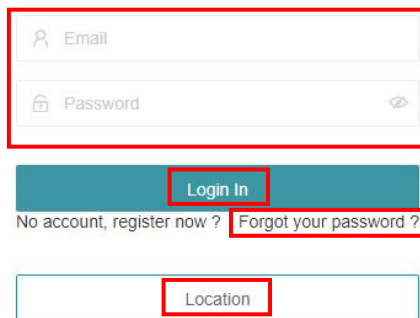

The login form includes fields for Email and Password. Below these is a Login In button and a link for users who forgot their password. At the bottom is a Location field.

5. Enter the registered email account and password

6. Click "Login" to enter My Cloud Templates

Remarks: If you forget your password, click here to change it

If you do not want to log in to the account and enter the software directly, click "Local Mode" to enter without logging in

## 4.2 WTDDesigner Template Design Tool Function

WTDDesigner Template Design Tool is a template creation tool and template resource, WTDDesigner Template Design Tool can be used as a template in ink water screen series products. Uses APP-produced model boards, cloud model boards, shared model boards, stocked model boards, and lower model boards. On the electronic version of WTDDesigner Template Design Tool, you can use the new model board, you can enjoy the new model board, and the new model board can be registered. You can use the model board to download or save the model board in the community, and use the model board for download. Users with multiple series of G series and S series devices can install S series plug-in extension functions, so that they can send templates through the template design tool to refresh S series devices without downloading S series software.

WTDesigner Template Design Tool also owns the electronic version of the hand machine APP version.

This tool's functional attributes are divided into seven major functional modules: new construction / my text box / recently modified / My Cloud Templates / my collection / model board community / return station/Plugs. Right-side cutaway language mention My Cloud Templates In addition, the language management My Cloud Templates can be used on the right side. Below is a detailed description of each functional module.

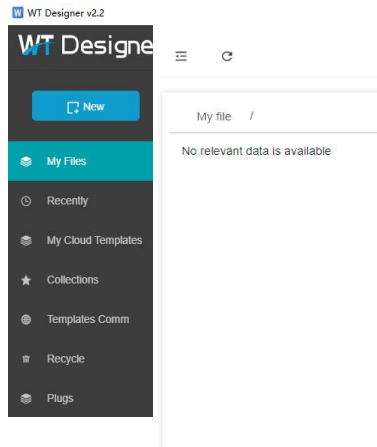

#### 4.2.1 Module 1: New

##### 1) New A Folder:

Create a folder before creating a template, and then create a template, which will be more convenient in terms of operation and category management. Methods as below:

Click "New" → "New Folder" → enter the folder name → click "OK" to view the newly created folder in My file.

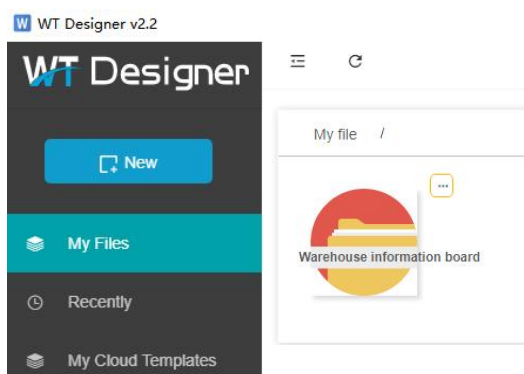
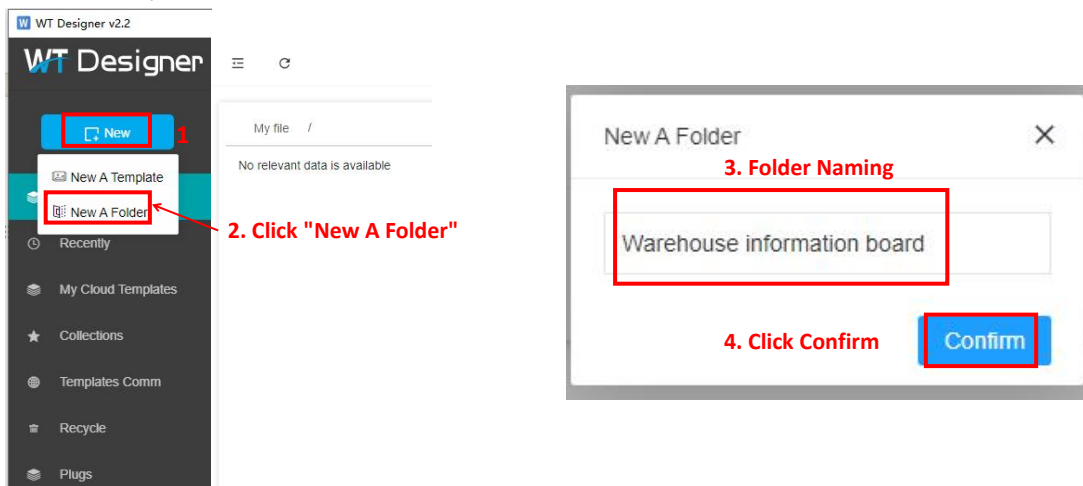

View the newly created folder in my file

## 2) New A Template:

Click "New" → "New Template" → enter the "Template Name" that needs to be customized → select "Template Size" to display the selected pixel size and palette display color (Note: BWR is black and white red / BW is black and white , select the size and color of the template to be created according to the actual size and display color of the device) → click "OK" to enter the DIY template editing interface.

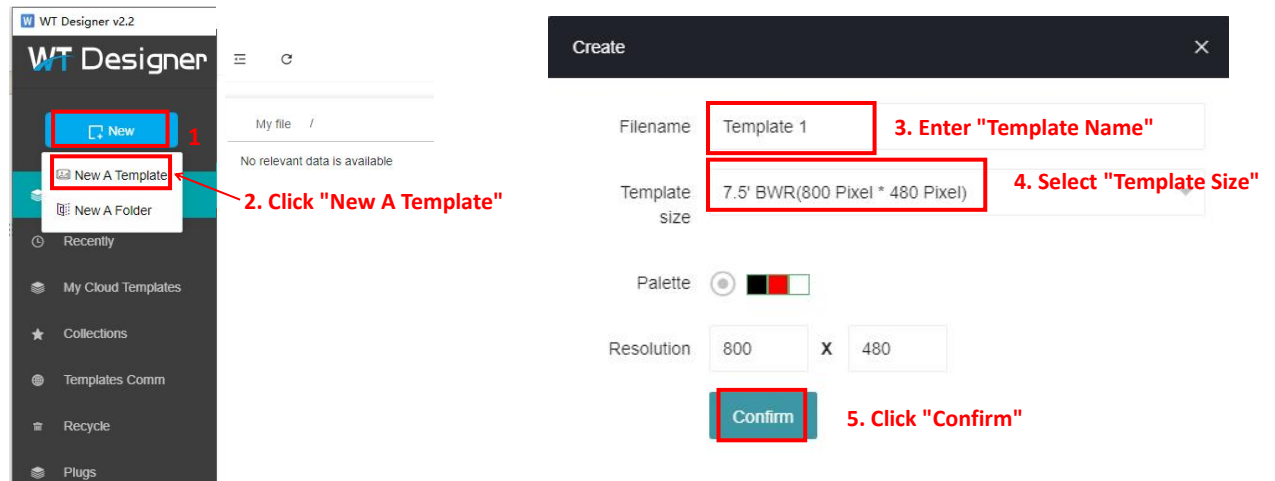

After entering the DIY template editing interface, you can use the tools on the left to design and make templates, as shown above. Tools include: text, rectangle, rectangle, circle, ellipse, square, single line segment, barcode, QR code, picture, tabulation, etc. Click a tool icon with the mouse, and the corresponding tool icon will be displayed in the template area. On the right, you can set the background color, line color, line width, alignment, font color, font and font size, etc. When clicking the barcode and QR code, you can set the barcode and QR code format style properties on the right side. When you click on the picture, you can choose to upload the logo and picture, and you can set the effect of shaking or not shaking the picture.

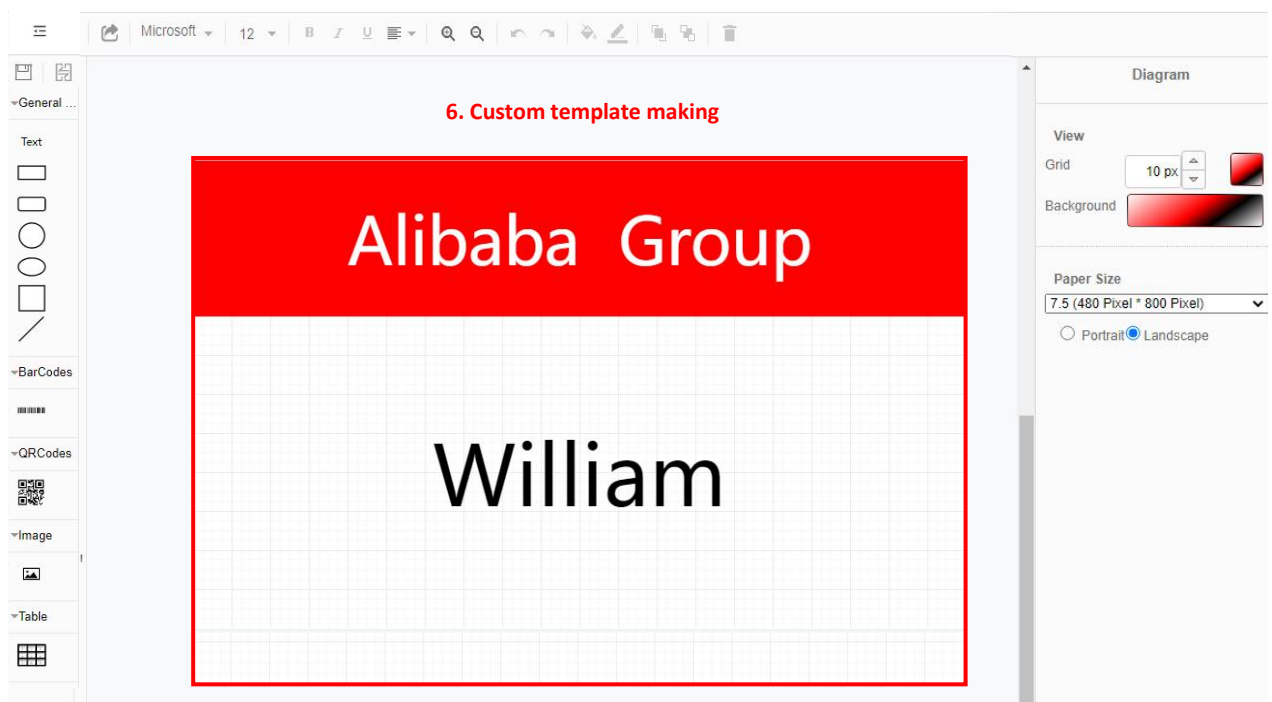



7. After the template is created, click here to save or press ctrl+s to save

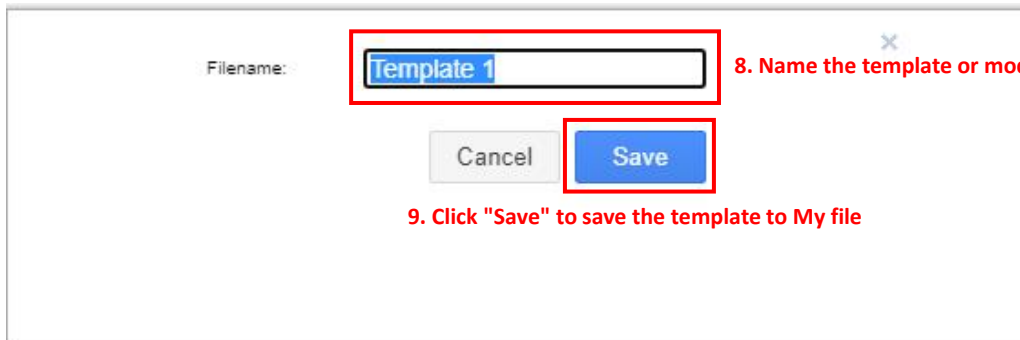

8. Name the template or modify the template name

9. Click "Save" to save the template to My file

#### 4.2.2 Module 2: My file

The template in the middle of the selected text box is displayed in the upper right corner...There are multiple names, categorization, movement, exclusion, and other attributes such as text boxes. My Cloud Templates display, register APP or use My Cloud Templates immediately download this model board.

- Rename: You can change the name of the template.
- Clone: A template can be copied for modification and use.
- Move: The template can be moved to a newly created file for classification management.
- Delete: The template can be deleted.
- Cloud : Templates can be sent to My Cloud Templates of your own account and saved.

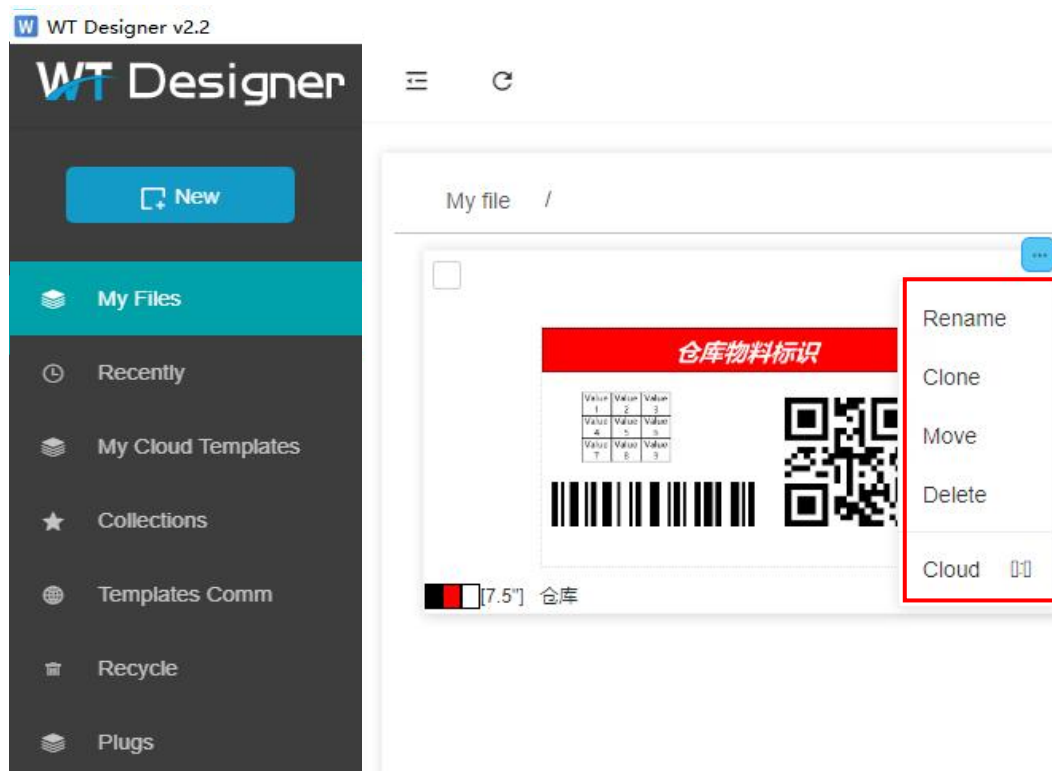



### 4.2.3 Module 3: Recently

This module displays the history of the most recent "New Templates" and the most recent "Modified Templates".

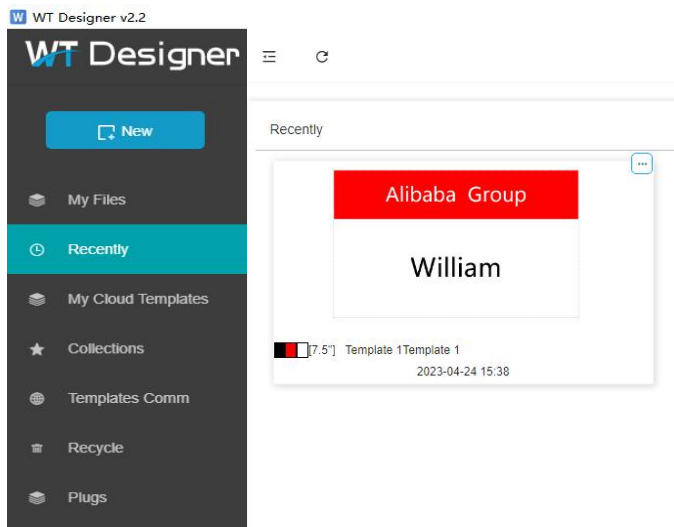

Currently being modified, the upper right corner of the model board can be set. You can also directly point to "Cloud" on My Cloud Templates.

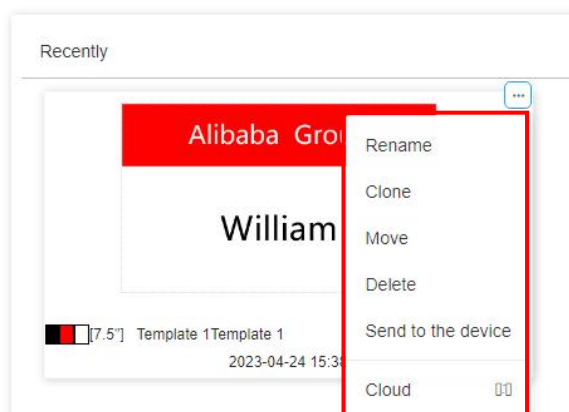

### 4.2.4 Module 4: My Cloud Templates

If you enter the software in local mode and click "My Cloud Template", it will prompt "Please login to your account first" → click the "Confirm" page to jump to the login page. At this time, click "Account Registration" and you can enter after the registration is completed. My Cloud Template (see page 15 of this manual for specific account registration operations) → After registration is completed, enter the registered email account and login password → Click to log in → You can enter My Cloud Template.

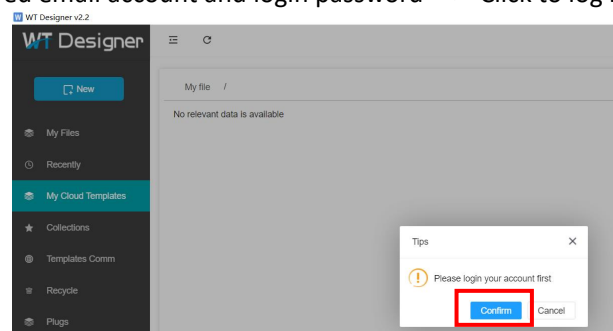

Click "My Documents" or the "Recently Modified" template → click the upper right corner of the template... → click "Cloud Document" → click "Save Cloud Document" to store the newly created template on My Cloud Template. Store the template in my cloud template account, and it can be used at any time and is safe even if you change the computer to log in or reinstall the system.

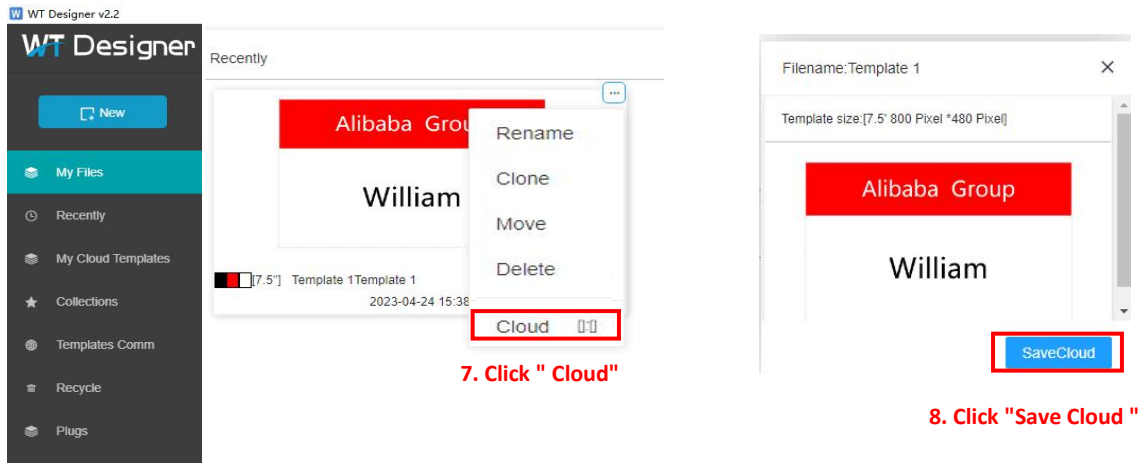

Save the template of the cloud document to store this template in My Cloud Templates, and automatically classify it according to the size of the template

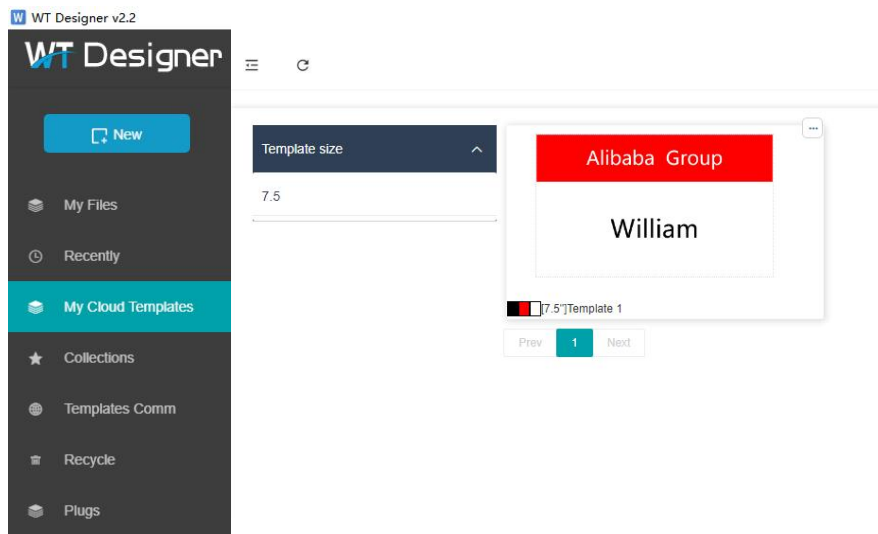

The "Batch Operation" in my Cloud Templates module can set attribute functions such as select all, delete, and share.

①Select All: Click Select All to select all the templates, if you cancel all the selection, click Refresh to cancel the selection. If you choose a single option, you can directly check the desired template.

②Delete: Select one or all templates to be deleted, and click Delete to delete the template from My Cloud Templates.

③Share: Select one or all templates that need to be shared, and click Share to share the selected templates with other users' mailboxes.

Click "My Cloud Templates" → select the templates that need to be shared → click "Batch Operation" → click "Share" → enter the email addresses that need to be shared with other users → you can share the selected templates to the other users' email addresses. → There will be a message prompt in the other party's mailbox → Click to open the message → A shared template file message will appear → The other party will click to accept, and the template will be stored in the My Cloud Template module of the other party's mailbox for the other party to use.

Remarks: When sharing templates, please be careful not to share with the email account you are using or email users who have not registered this software. If you share, the sharing will be invalid and the feedback will display "illegal email".

**2. Select one or all templates to share**

**3. Click "Share"**

**4. Enter the email account to be shared**

**5. Click OK, and the other party's mailbox will receive the template file message**

**6. Click the message to share the template file**

**7. Click to accept, the template can be used in My Cloud Templates**

ID	Share	Number of shared templates	Share date	Operation
1	sales@witstec.com	1	2023-07-13 11:32:46	Accept

#### 4.2.5 Module 5: Templates Community

Click "Template Community" → you can search for the desired template through the four places of search box, color, name, and size → click the desired template and click the upper right corner... with properties such as view, collection, download, etc., click the desired property Make settings for the template.

→View: You can preview the template.

→Favorites: You can add your favorite templates to my favorites.

→Download: The template can be downloaded to My Documents for use.

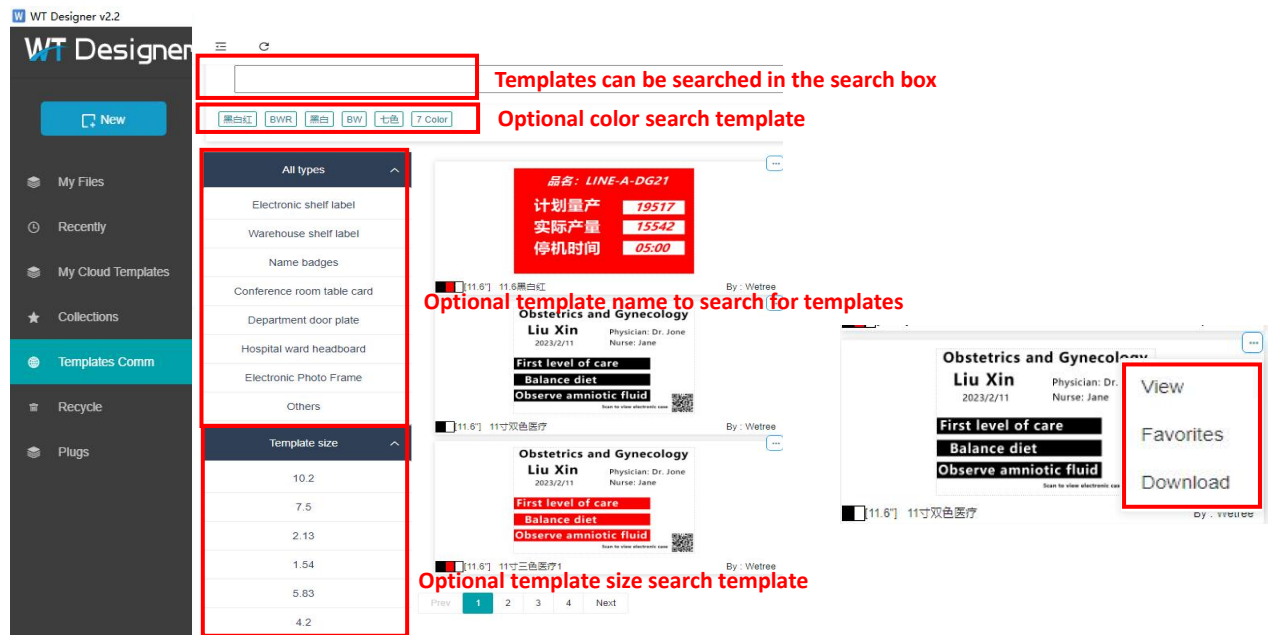

#### 4.2.6 Module 6: Collection

This module displays the favorite templates, and the favorite templates are automatically classified into my favorites according to the name and size. Users can add their favorite templates to my favorites in the template community.

Click on the favorite template and click on the upper right corner... with properties such as viewing, downloading, canceling favorites, etc., click on the required properties to set the template.

→View: You can preview the template.

→Download: The template can be downloaded to My Documents for use.

→Unfavorite: You can cancel the favorite templates and remove them from the favorite templates.

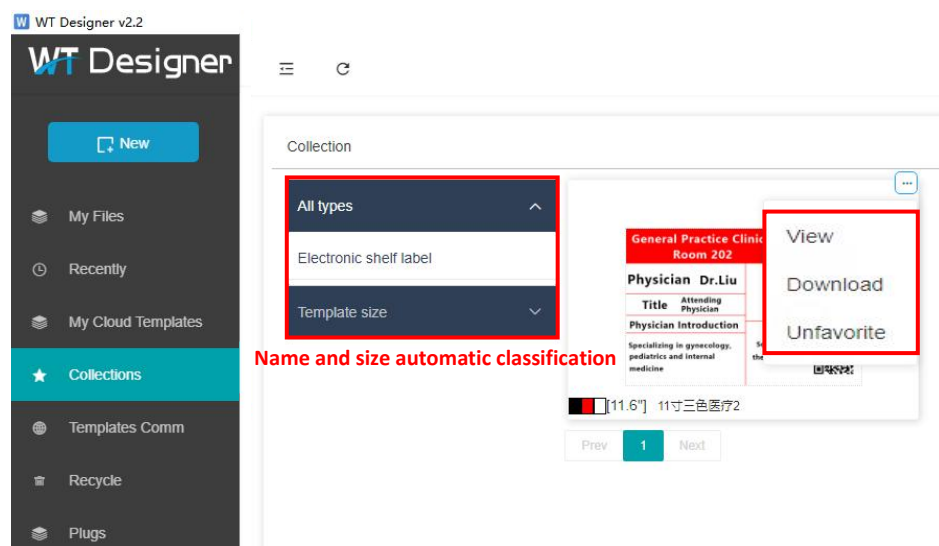

#### 4.2.7 Module 7: Recycle

The recycle is used to store template data temporarily deleted by the user → click the upper right corner of the template... to permanently delete and restore the template stored in the recycle.

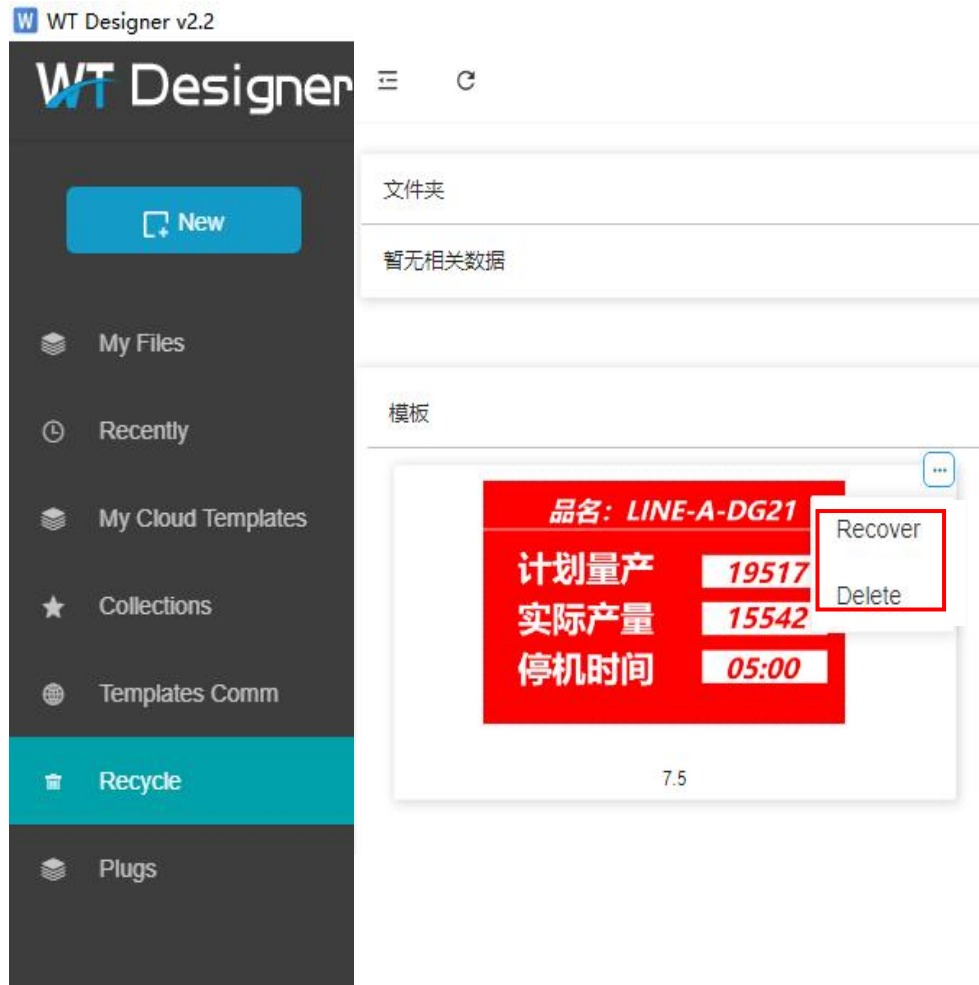

#### 4.2.8 Module 8: Plugs

WTDegnsier template design tool version 2.0 and above has this Plugs function

This plug-in supports the mapping function of S-series devices, so that users who have both G-series and S-series devices can have two softwares only by using the software WTDegnsier template design tool and installing the S-series Plugs function. function. In this way, you can send templates through the template design tool to refresh S series devices without downloading the S series software.

Click "Plugs" → Install the plug-in → The installation will be successful. After the installation is successful, you can perform sending operations under the five modules (see the S series manual for specific operation instructions) → Click Uninstall the plug-in to remove this function. This S A series of plug-ins can be installed and uninstalled repeatedly and operated as needed.



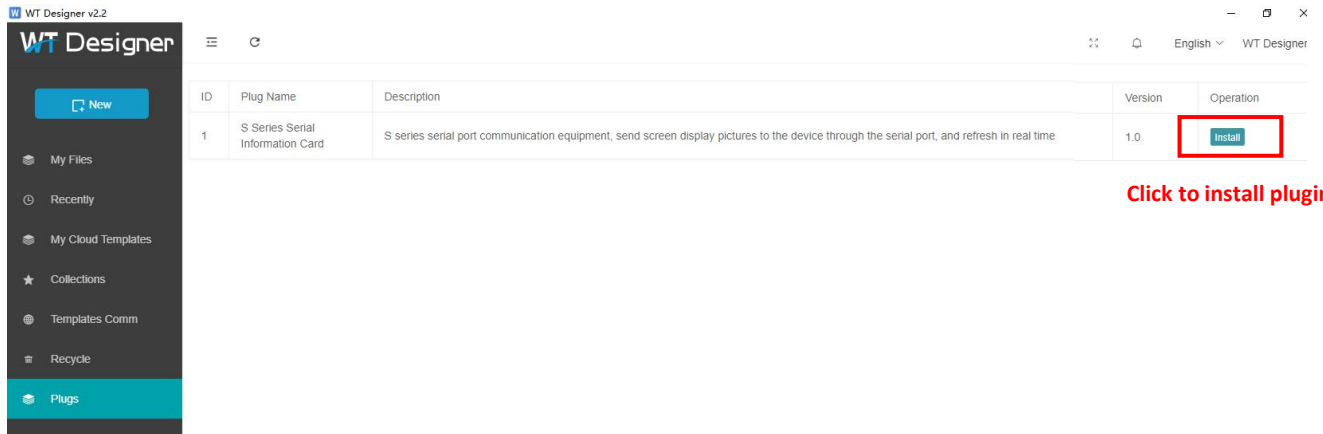

Click to install plugin

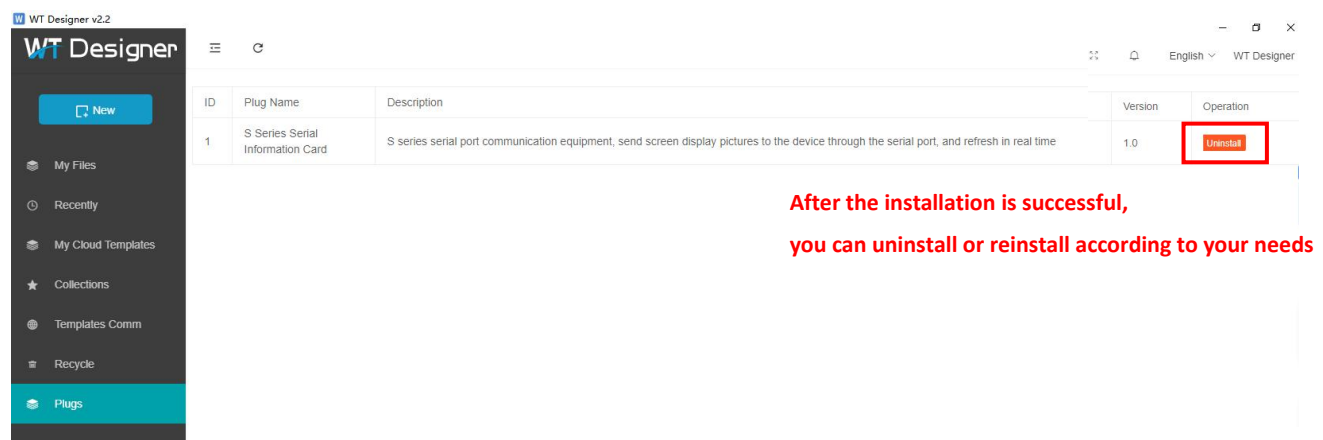

After the installation is successful,  
you can uninstall or reinstall according to your needs

## 5、Briefly Describe The Steps To Update The Template

This chapter briefly describes the steps to update the template. Please note that before updating the self-drawing template, you need to make the template first, update the template in the "Template Community", and select the template directly.

Step 1: Download the WT E-Paper mobile APP

Step 2: Register the login account of APP

Step 3: Turn on the mobile phone Bluetooth and APP Bluetooth/location permission function

Step 4: Create a template with WT E-Paper APP/WTDegnsier template design tool

Step 5: Add Devices

Step 6: Name the device

Step 7: Connect the device

Step 8: Select the template to be sent, and click Refresh Template

## 6、 Briefly describe the steps of WTDegnsier template design tool

This chapter briefly describes the steps for interoperating and sharing templates with My Cloud Template in WTDegnsier template design tool. Please note that before interoperating and sharing, you need to register the template and My Cloud Template account first. If you have registered my cloud template account, you can log in directly.

Step 1: Download and install WTDesigner For Serial Port software

Step 2: Create a new folder on the WTDesigner For Serial Port software

Step 3: Create a new template on WTDesigner For Serial Port software

Step 4: After logging in to My Cloud Templates, you can communicate and share templates in the following ways:

Template interoperability: My Documents → select a template → click the upper right corner of the template... → select "Cloud Documents".

Template sharing: My Cloud Templates → Select the template to be shared → Click "Batch Operation" → Click "Share" → Enter the email address to be shared → the selected template can be shared to the other party's Cloud Templates email account.

Step 5: After installing the S series plugs in version 2.0, you can send the template to the device under the following five modules:

Module 1: My Documents → Select Template → Click the upper right corner of the template... → Select "Send to Device".

Module 2: Recently modified → Select the template → Click the upper right corner of the template... → Select "Send to device".

Module 3: My Cloud Template → Select the template → Click on the upper right corner of the template... → Select "Send to Device".

Module 4: My Favorites → Select a template → Click the upper right corner of the template... → Select "Send to Device".

Module 5: Template Community → Select a template → Click the upper right corner of the template... → Select "Send to Device".